

# SPECCTR 3.0

Tutorial + Tips

# Features

## NEW FEATURES

- ONLY AI
- ▲ ONLY PS
- ONLY ID

### GLOBAL FEATURES

- ● » Expand Canvas
- » Movable/editable labels
- » Specs organized in layers
- ● » Multi-spec, spec multiple objects
- » Number -or- line specs
- ● » Art boards compatible
- » Add notes

### SETTINGS

- » Formatting spec text + line weight
- » Spec line weight
- » RGB/ HEX/ HSB/ HSL/ CMYK/ SPOT
- » Spec units are set in Adobe's global preferences: px, points, inch, mm
- » Different color for each spec types
- » Label position control
- » Decimal vs fraction
- » Include Stroke in measurement
- » Scale specs by 1x, 2x, 1/2x etc.
- » Place spec on canvas edge toggle

### MEASUREMENTS

- » Width & height
- » Coordinates
- » Spacing between object and canvas
- » Spacing between multiple objects
- » Spacing between text objects
- » Spec placement location control

### RESPONSIVE OPTIONS

- » Spec distances in %
- » Spec type in em
- » Spec type in em
- » Hex, RGB, iOS RGB as %

### OBJECT

- » Layer name
- » Fill Color
- » Stroke color, size, style
- » Opacity / filter
- » Border radius

### EXPORT

- » Specs to CSS
- » Specs to Cloud

### TEXT

- » Layer name
- » Font family
- » Size
- » Fill color and style
- » Alignment
- » Line Height
- » Letter Spacing
- » Opacity

### CLOUD PROJECTS BETA\*

- » Sync styles to projects page
- » Share projects with other users
- » Preview CSS
- ▲ » View a screenshot of the latest version of your document

# Panel Overview

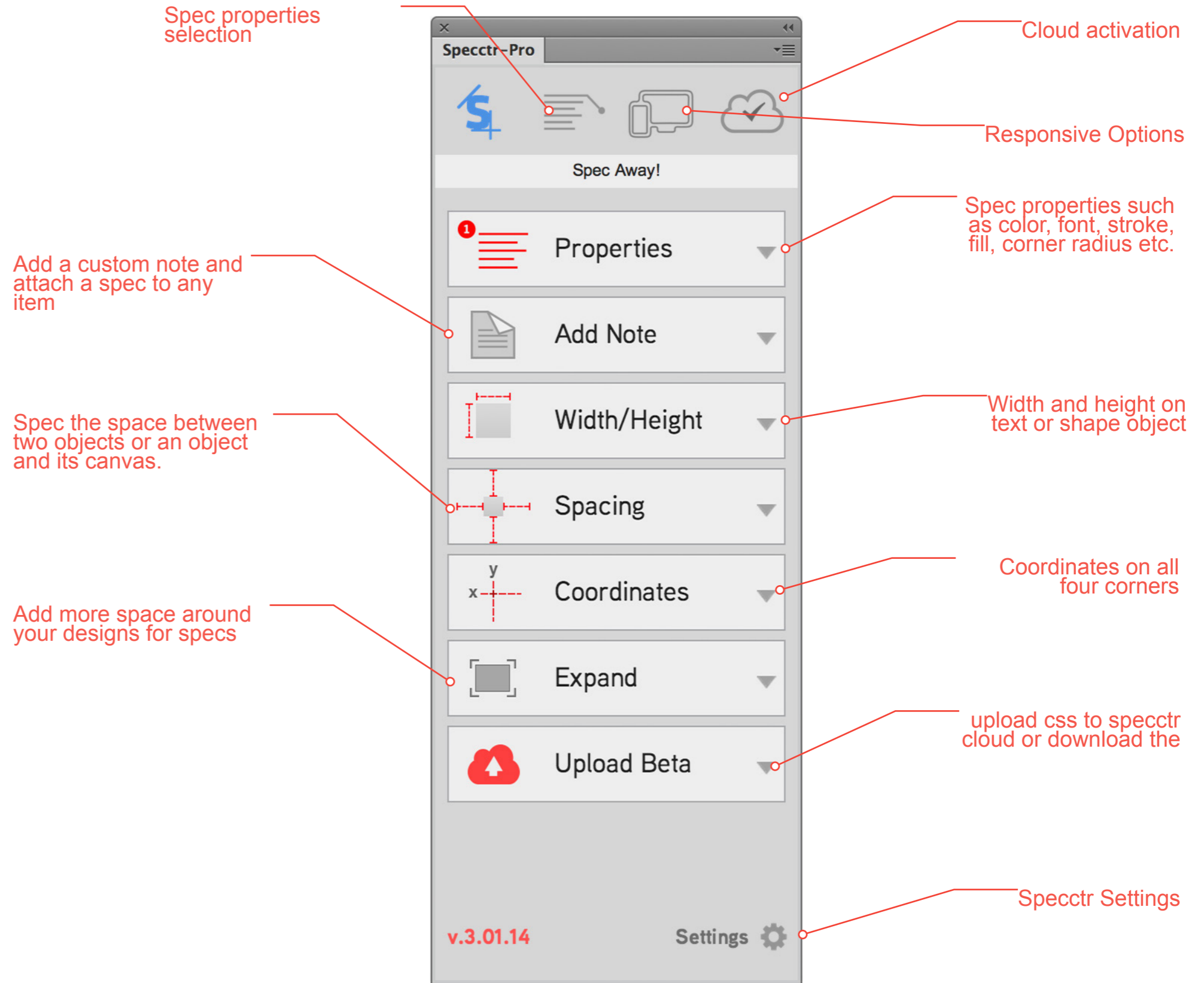

# Installation Instructions

## INSTALLATION REQUIREMENTS

Mac OSX or Windows

Adobe Illustrator: CC 2017  
Adobe Photoshop: CC 2017  
Adobe InDesign: CC 2017

## HOW TO INSTALL?

1. Download Specctr installer ( .mxp or .zxp)
2. Double-click to open Adobe's Extension Manager
3. Read our user license agreement and hit "Install"
4. Restart Photoshop/ Illustrator / InDesign
5. In Photoshop/Illustrator/InDesign Go to Window Menu > Extensions and select Specctr
6. Log in with your e-mail and Specctr Cloud password
7. Spec away!

# Settings

**Formatting:**

- » Set your spec options. Pick the font family, size and color for each spec type.
- » Set your line weight.

**Properties:**

- » Decide which color mode to spec with: HEX, RGB, CMYK, HSB, HSL, or iOS (RGB as %).

**Measurements:**

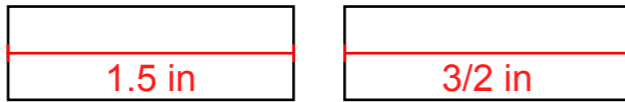

The new scale feature gives you the control over dimension specs. The scale feature is especially useful for retina displays and multi media projects.'

Scale X1

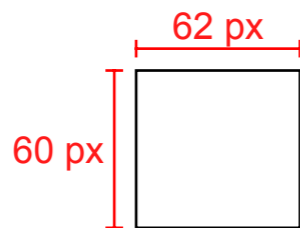

Scale X2

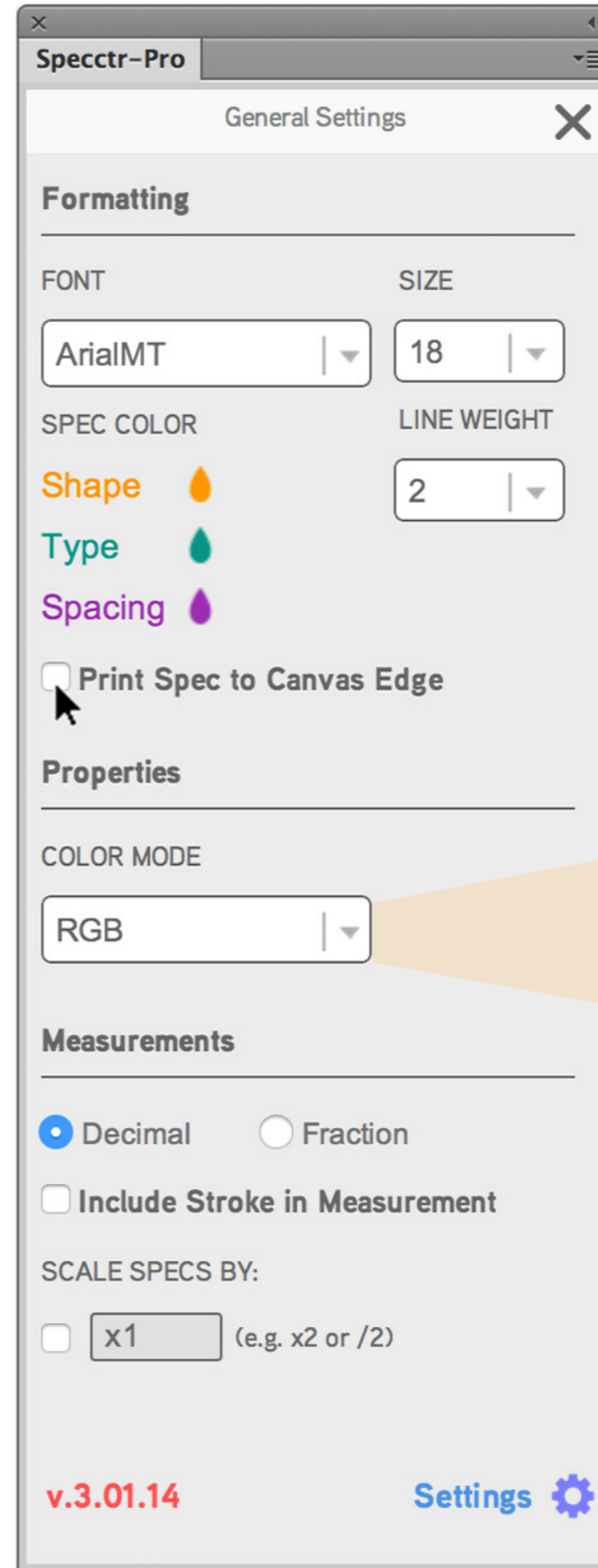
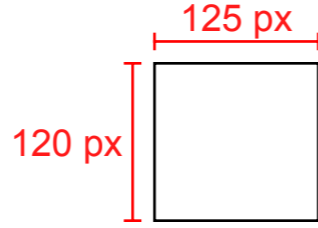

# Responsive Option

This enables you to spec distances and spaces with %. To activate this feature select the check box.

Then add the dimensions of your document width and height. Now all of your distance / spacing specs will appear as %

Creating a relative system for your typography is also important for responsive designs. To spec in em simply select the check box.

By default Specctr will use a base font size of 16px and line height of 22.4px.

You can edit and change this to match your project needs.

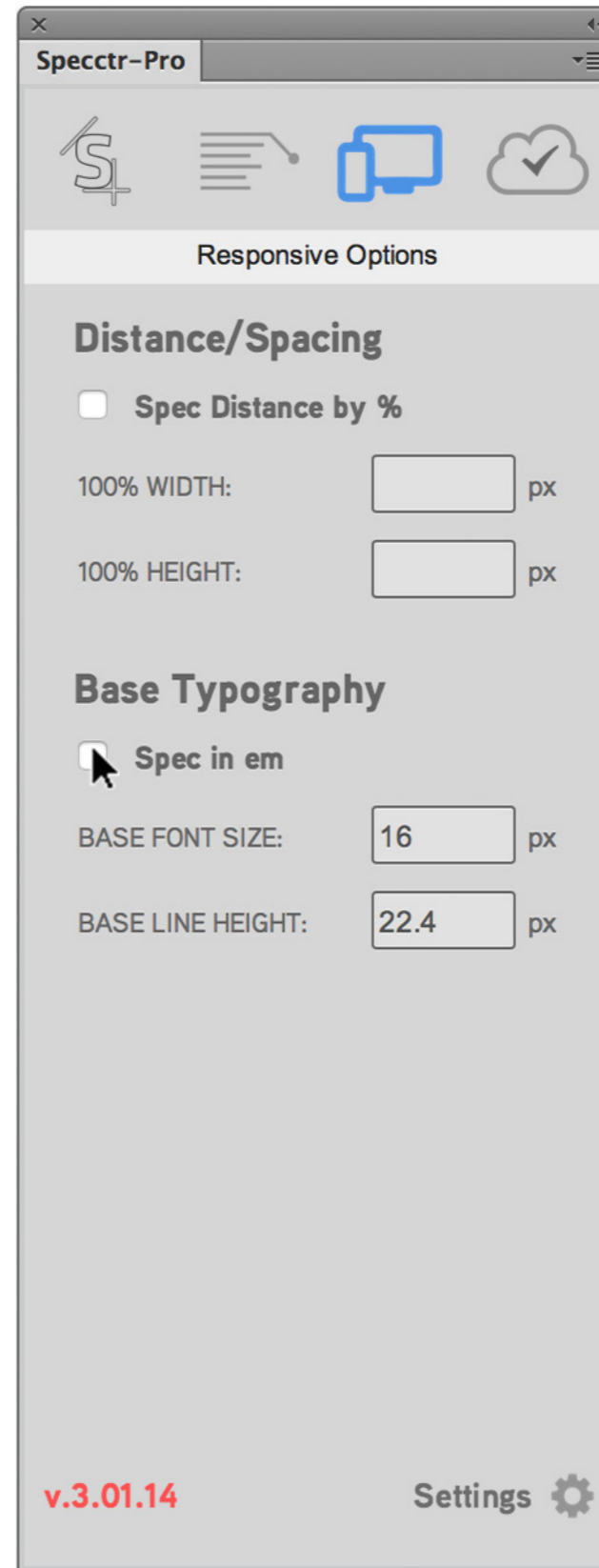

Select the details you want to display

Select which details are relevant and that you want to display for both text and shape objects.

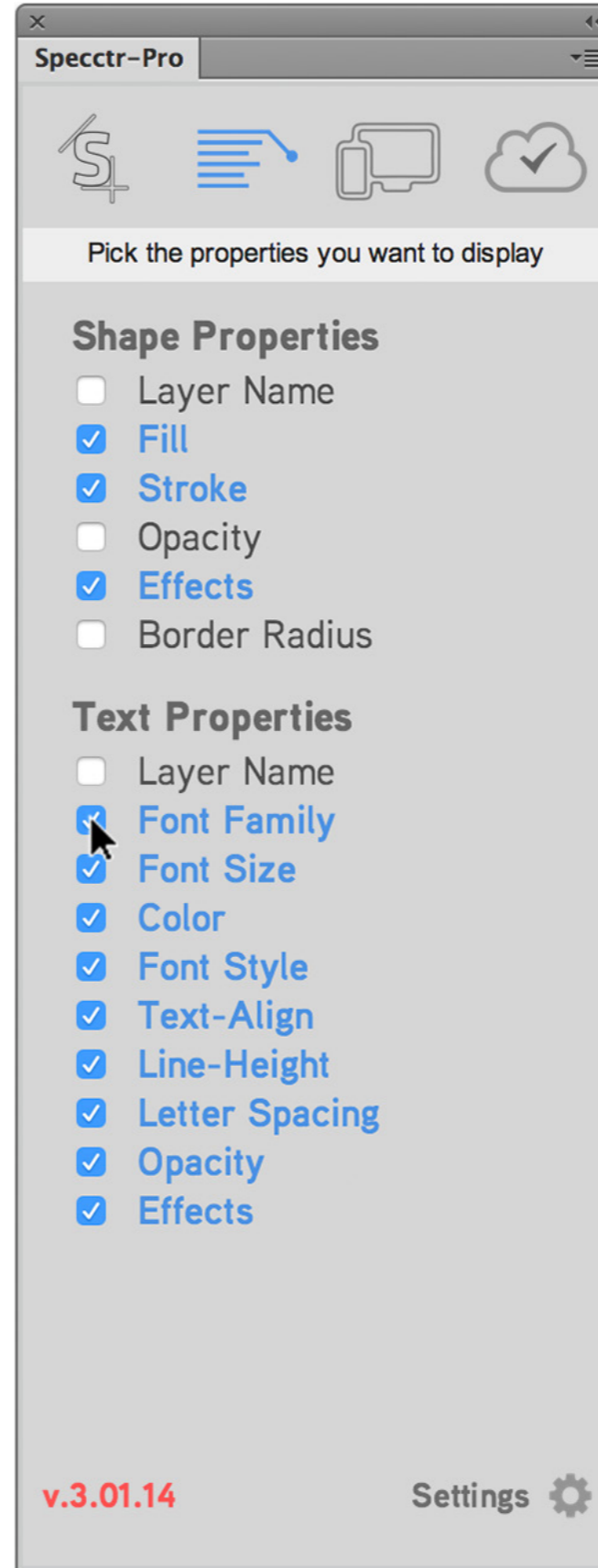

# Spec away!

Click any object on screen and click the spec button.

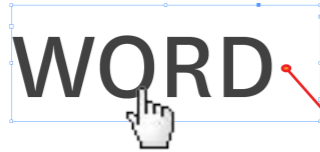

h1  
Font-Family: ArialMT  
Font-Size: 12 pt  
Color: #f6881f  
Font-Style: normal  
Text-Align: right  
Line-Height: 14.4 pt  
Letter-Spacing: 0 em  
Opacity: 1

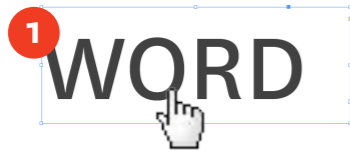

1 h1  
Font-Family: ArialMT  
Font-Size: 12 pt  
Color: #f6881f  
Font-Style: normal  
Text-Align: right  
Line-Height: 14.4 pt  
Letter-Spacing: 0 em  
Opacity: 1

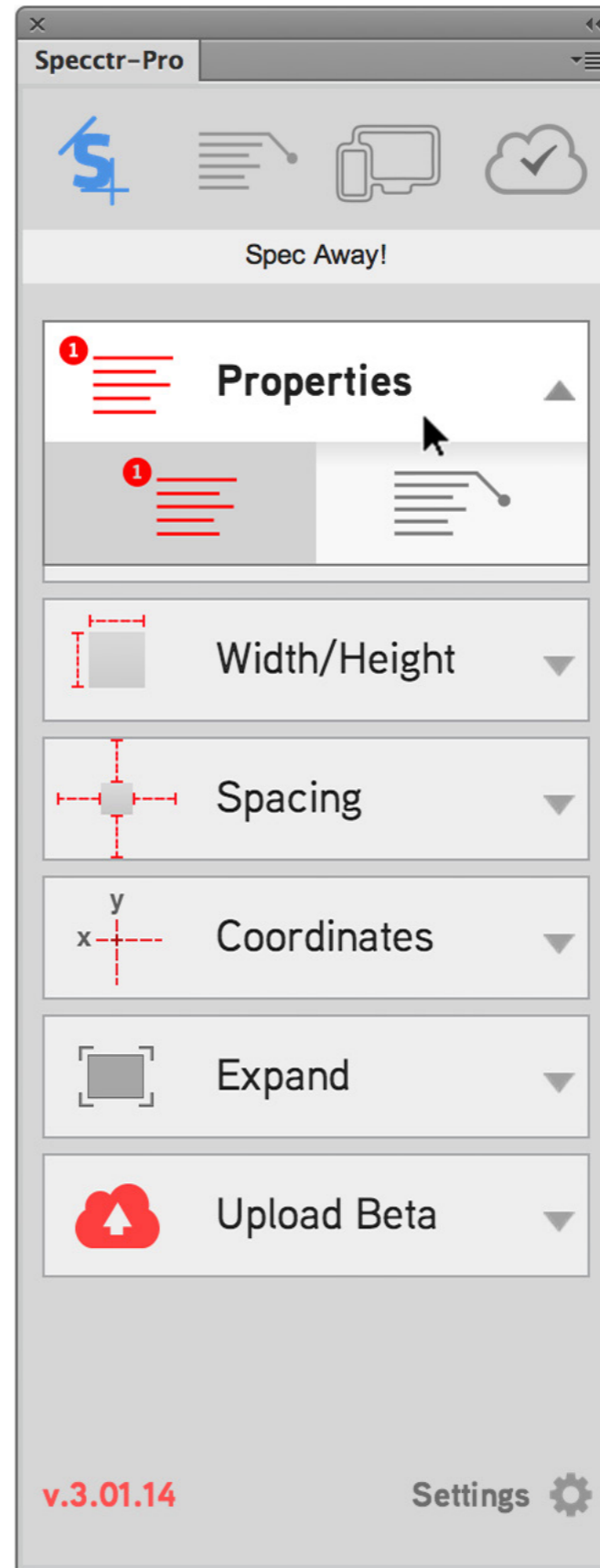



# ADD A CUSTOM NOTE



Always align text and shape objects in the same column.

Write a note in the dropdown. Select objects and click to attach it. This makes it easy to duplicate notes accross your document.

Always align text and shape objects in the same column.

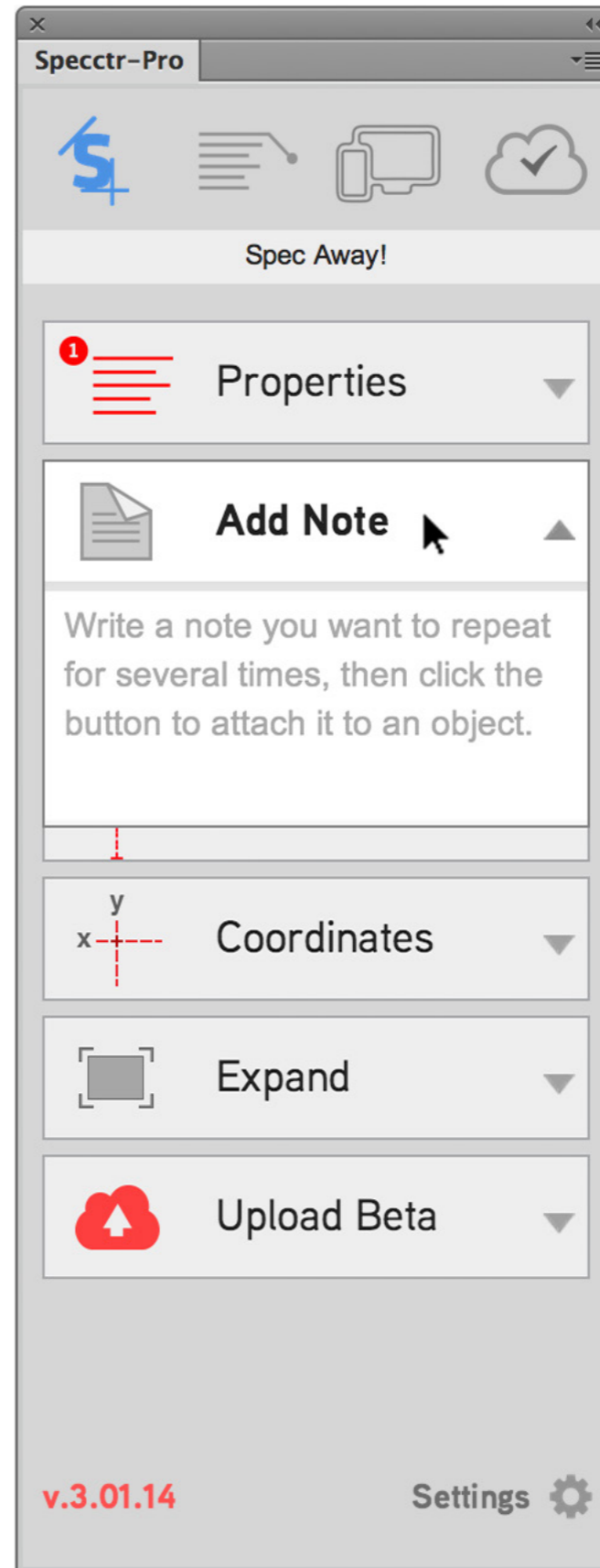

# Spec dimensions

To spec the dimensions you can select on which sides you want the dimensions spec to display.

Simply click and an shape object or text box to display the dimensions.

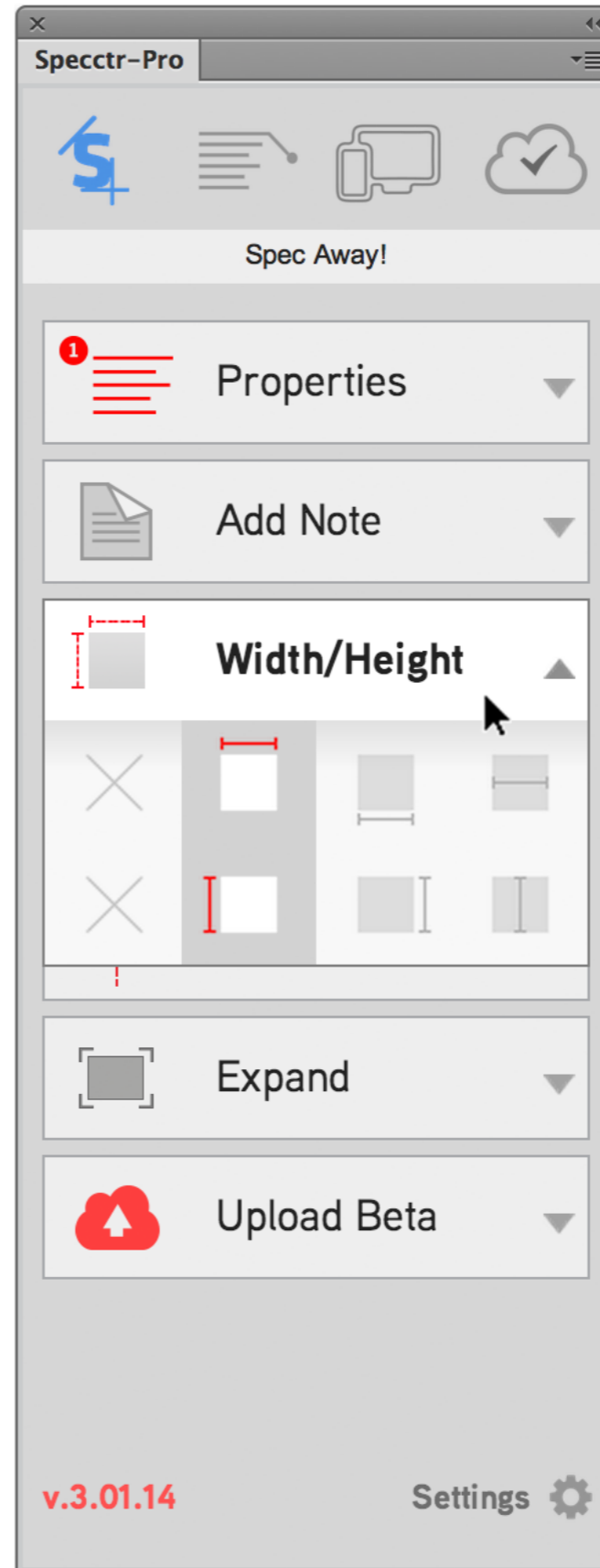
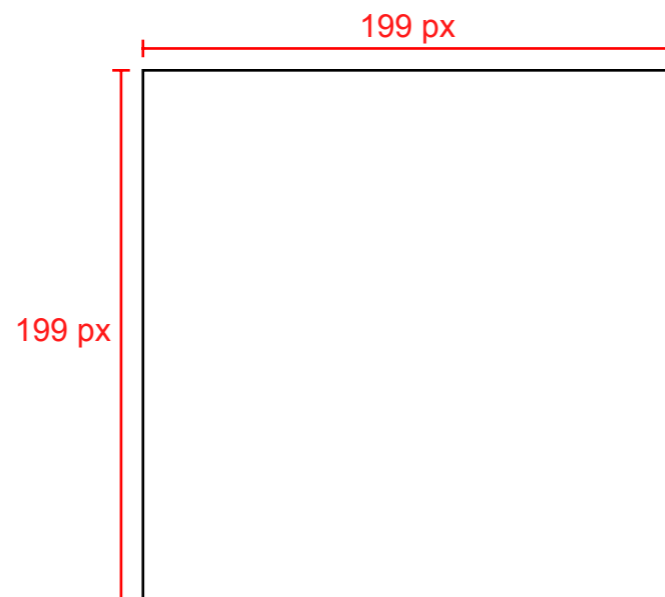

# Spec Spacing

To spec the spacing between a single object and the canvas edge. Click a single object and the Spacing Spec button.

To spec the distance between two objects. Select both using the Shift key and hit the Spacing Spec button.

Select a single or multiple sides of the object to spec.

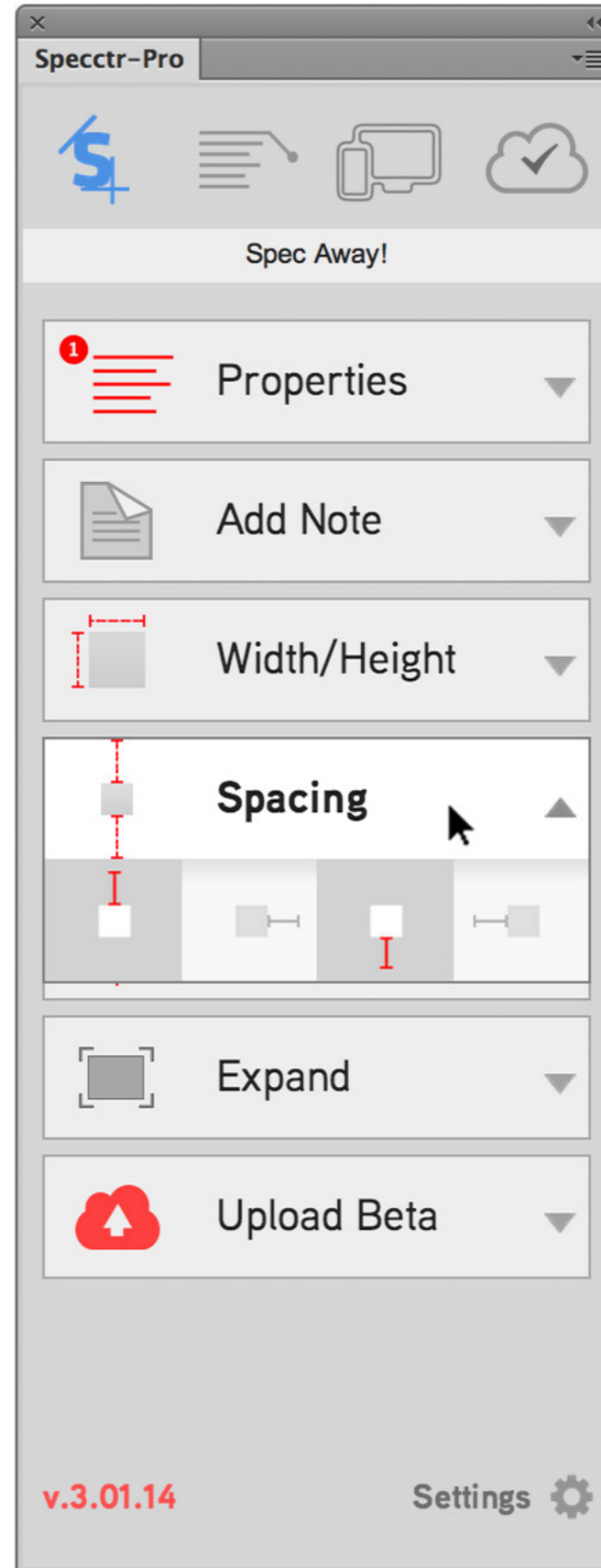
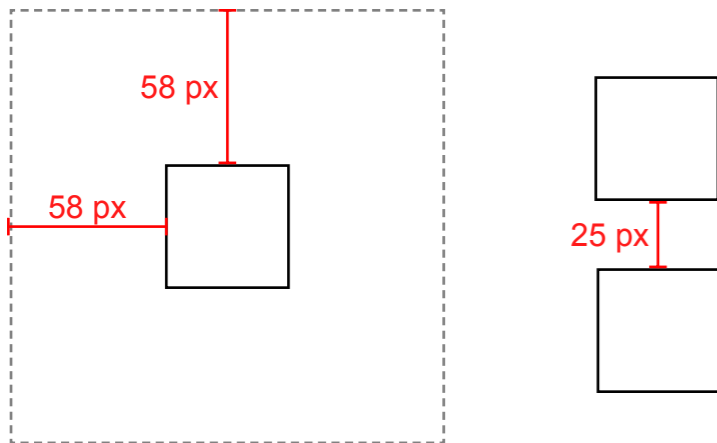

# Spec Coordinates

Click on any object to spec its X and Y coordinates.  
Pick your corner. Select which corner you want the measurement to be calculated from.

x: 138 px y: 299 px

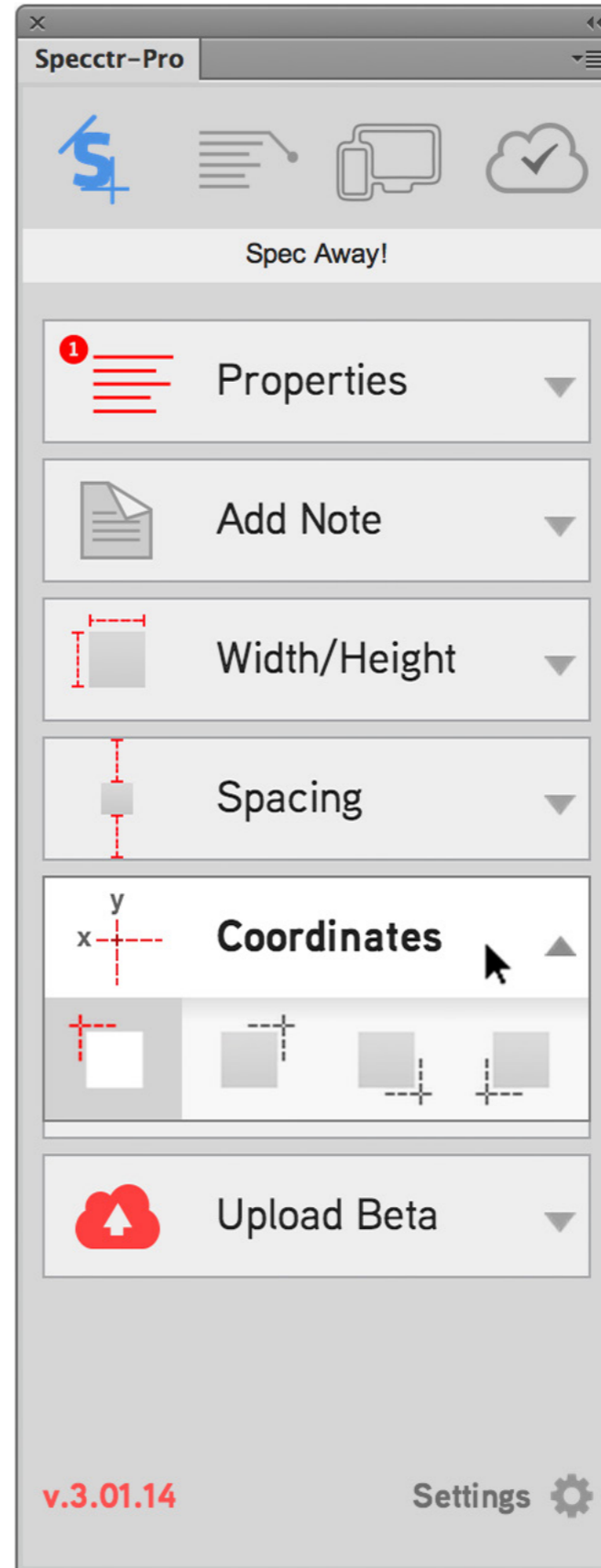
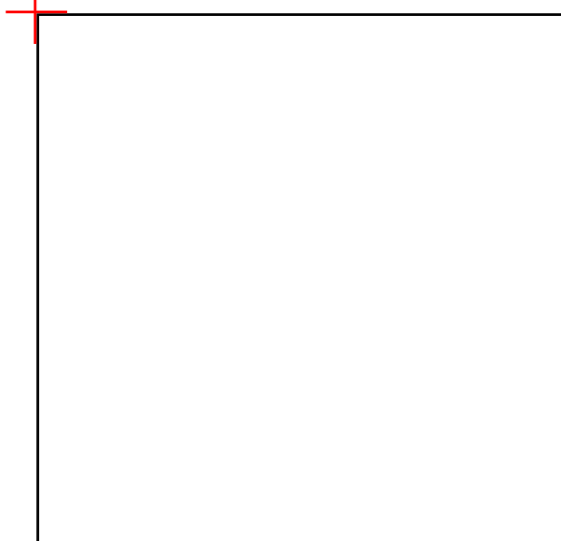

# Spec Layers

Specctrs layers are organized into groups:

Text Properties, Spacing, Dimensions, and Object Properties. This makes it easy to hide and delete the spec layers quickly.

Notice that the title of you layer also becomes the title of your spec:

If you use the CSS Export button it will also automatically become your class name:

```
h1 {  
font-family: national;  
font-size: 1.88em;  
color: rgba(0, 0, 0, 1);  
}
```

